

174-137

SEE MAP

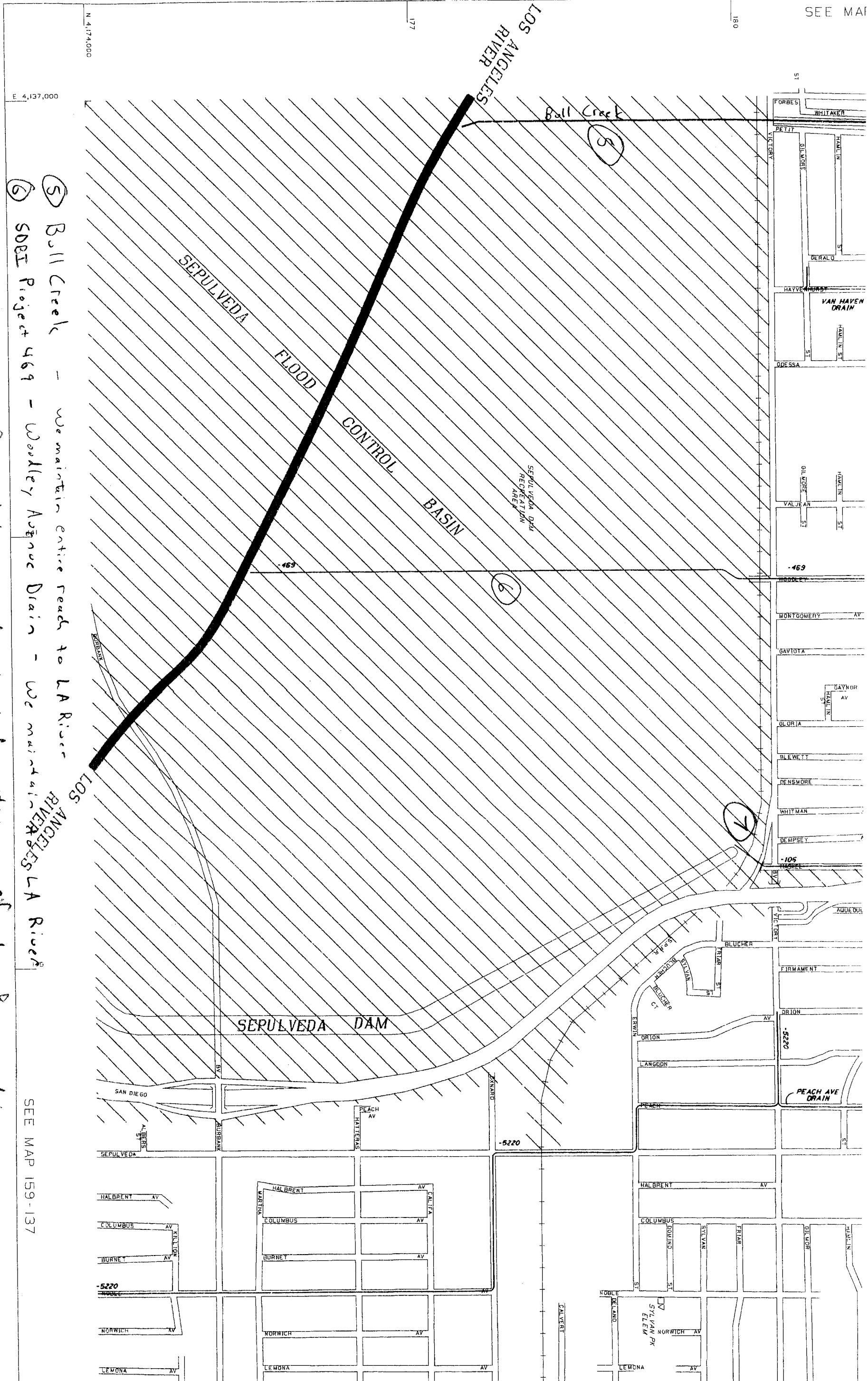

- ⑤ Ball Creek - We maintain entire reach to LA River
- ⑥ SDBGI Project 469 - Woodley Avenue Drain - We maintain LA River
- ⑦ SDBGI Project 106 - Our maintenance ends just downstream of the Bosway Line

SEE MAP 159-137

- ① SDBI Project 103 - Outlet of this drain is still 549-5200 Drain
- ② SDBI Project 5225 - Outlet of this drain is slightly in Basin
- ③ SDBI Project 472 - Underground Box we maintain to LA River
- ④ LA River West of MTA Bridge

SEE MAP 159-117

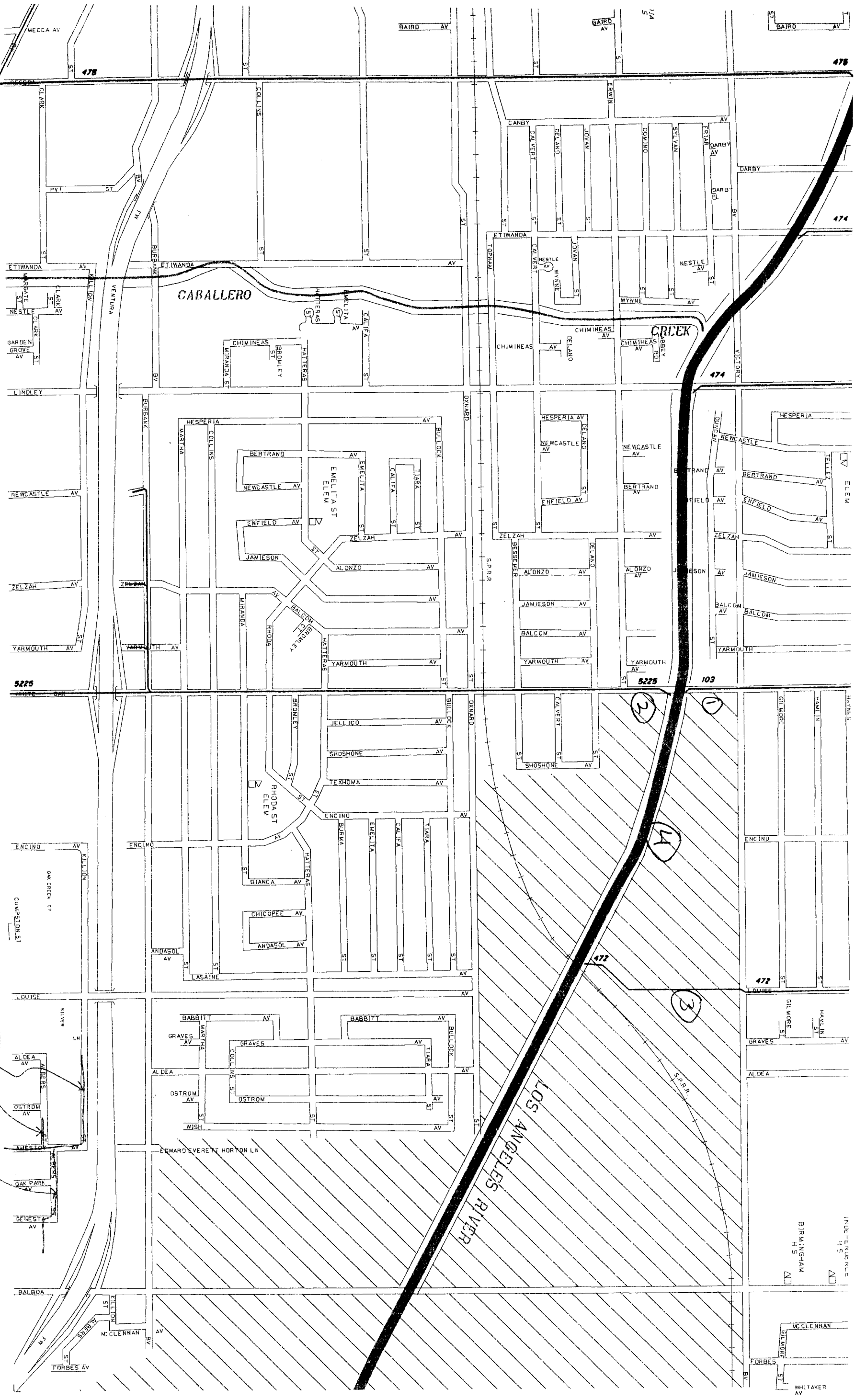

SEPULVEDA FLOOD CONTROL BASIN

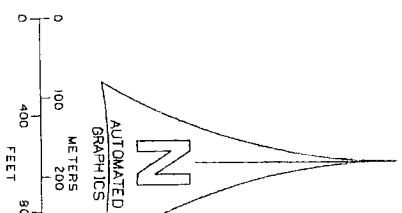

THIS MAP IS BASED ON INFORMATION AVAILABLE FROM THE COUNTY ENGINEERING DEPARTMENT. ANY LIABILITY FOR ANY INACCURACIES WHICH MAY BE PRESENT IN THIS MAP IS THE RESPONSIBILITY OF THE USER.

TRAVELED ACCESS FOR RIGHT TO TRAVEL NOT VERIFIED  
**DRAINS UPDAT**  
**MAY 1991**  
 REPLACED NOVEMBER 1990

LOS ANGELES COUNTY  
 MAP NO 174-1  
 DEPT OF PUBLIC WORKS  
 NOVEMBER 1990

549-5200  
 9-3-91  
 M. D. ...

PLEASE ABOVE THIS SENTENCE. THANK YOU

128-131



- 8 SDBI Project 5232 - Underground Drain we maintain until Freeway
- 9 SDBI Project 470 / Encino Channel - We maintain until the Box Drain that goes under Freeway
- 10 SDBI Project 5222 - Underground Drain we maintain until 100 feet east of Haskell
- 11 Haskell Venture Drain - We maintain this underground drain to a connection with LA River